

MODUL Q 100 AQUA LED.next

DECKENLEUCTE, SPRITZWASSERGESCHÜTZT / CEILING LUMINAIRE, SPRAY WATER RESISTANT

544-931 . 008-480 . 544-932

FÜR HOHLRAUMEINBAU
FOR PLASTERBOARD

nimbus^x

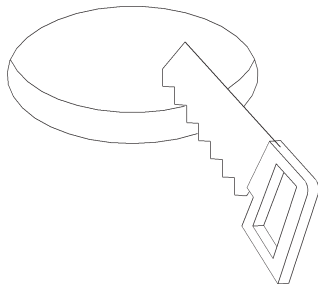
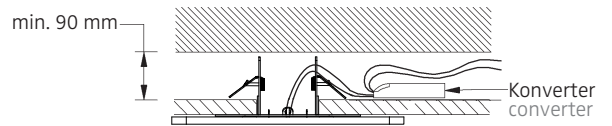

1

2

Anschluss an 230V AC
connection to 230V AC

Anschluss an 24V DC
connection to 24V DC

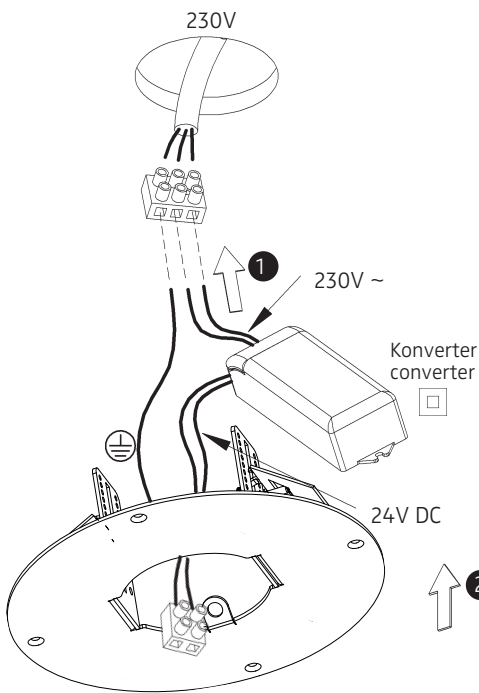

Der elektrische Anschluß darf nur vom Fachmann ausgeführt werden!
Must be installed by a qualified electrician only!

3

4

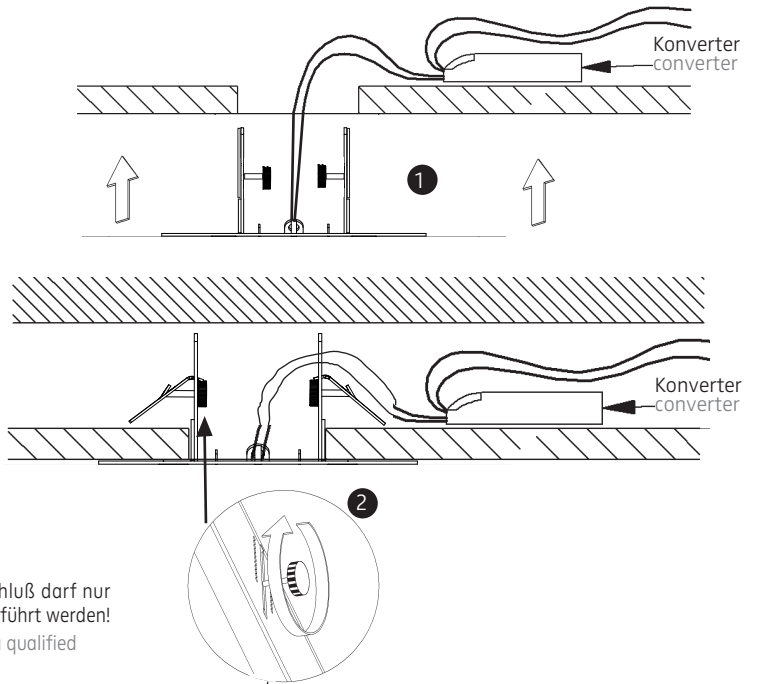

Sicherungsseil an Lasche befestigen!
Click safety rope into plate!

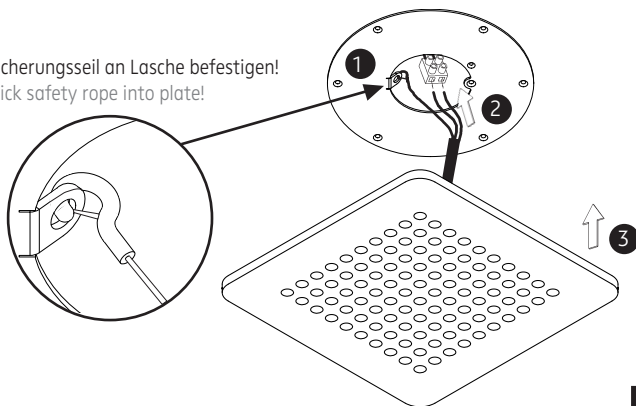

5

6

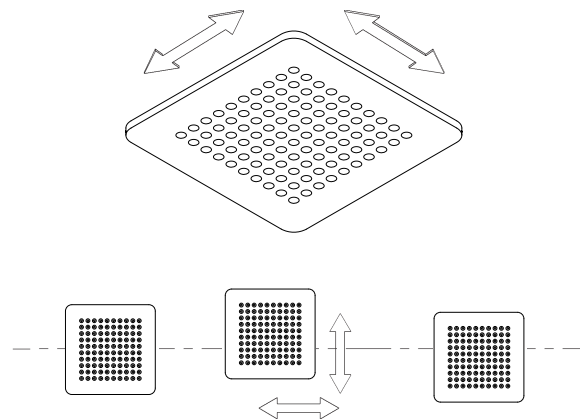

544-931 . 008-480 . 544-932

24V \equiv , Konstantspannung

24V \equiv , constant voltage

Bestückung: LED.next 21W

lamp type: LED.next 21W

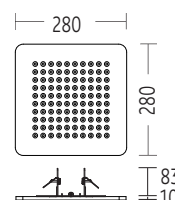

Schutzart IP 44
protection degree IP 44