

WINGLET CL

kabellose Wandleuchte / cableless wall luminaire

nimbus^x

MONTAGE DER WANDHALTERUNG

MOUNTING OF WALL BRACKET

Klebmontage / Mounting with adhesive tape

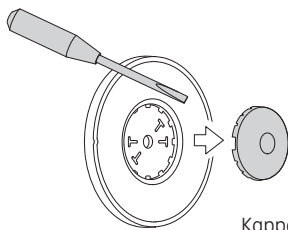

Kappe entfernen
Remove cap

1

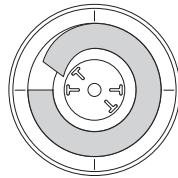

Den Aufkleber
anbringen
und Schutzfolie
abziehen
Attach the sticker
and remove the
protective film

2

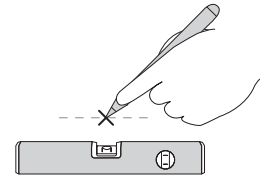

Horizontale Markierung anbringen
Make horizontal mark

3

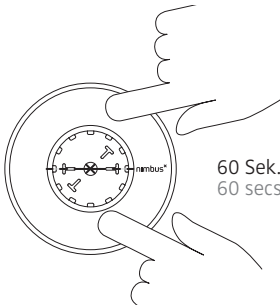

60 Sek.
60 secs

An Markierung ausrichten
und flächig andrücken
Align with mark and press
on by applying pressure
to whole surface

4

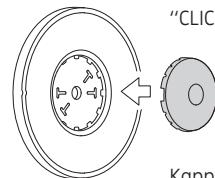

"CLICK"

Kappe wieder anbringen
Replace cap

5

Schraubmontage / Mounting with screw

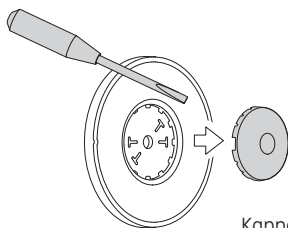

Kappe entfernen
Remove cap

1

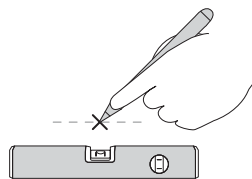

Horizontale Markierung anbringen
Make horizontal mark

2

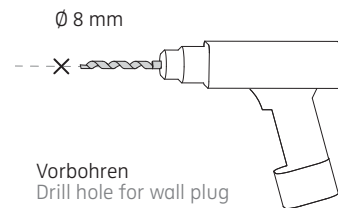

Ø 8 mm
Vorbohren
Drill hole for wall plug

3

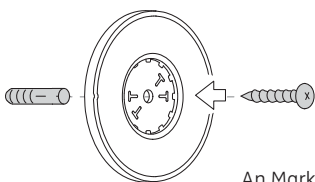

An Markierung ausrichten und anschrauben
Align with mark and screw onto wall

4

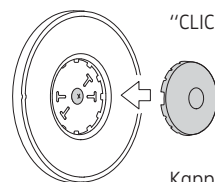

"CLICK"

Kappe wieder anbringen
Replace cap

5